

A simple plug-in Accessory Board for the Aquapro-3 series of Pump Controllers to provide BMS (Building Management System) connectivity and remote status telemetry.

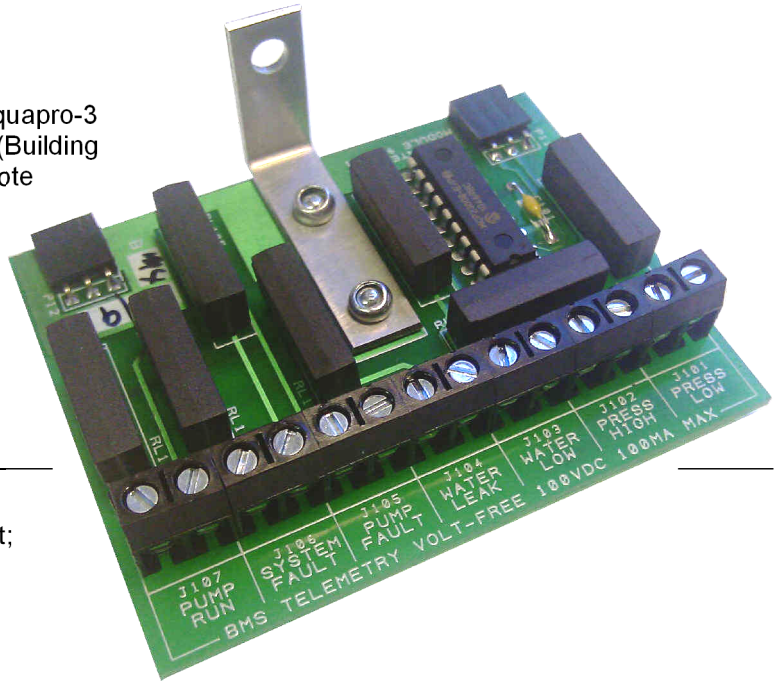

## SPECIFICATIONS

- m 7 Volt-Free Contacts, one for each event;
  - Pressure Low
  - Pressure High
  - Water Low
  - Water Leak
  - Pump Fault (any Pump)
  - System Fault
  - Pump Run (any Pump)
- m Each contact independent of others (normally OPEN - CLOSED on event)
- m Each contact rated at 100v 100mA (DC maximum - *non-inductive\**)
  - Contact life expectancy (@1v, 1mA) 1 x10<sup>6</sup> operations
- m True Plug & Play - seats directly into controller mainboard
  - (fully automatic configuration - no setups or other settings required)
- m Compatible with all Aquapro-3 series (and derivative) Pump Controllers
- m Dimensions 75mm x 60mm x 28mm (approx. including fixing bracket)

## INSTALLATION

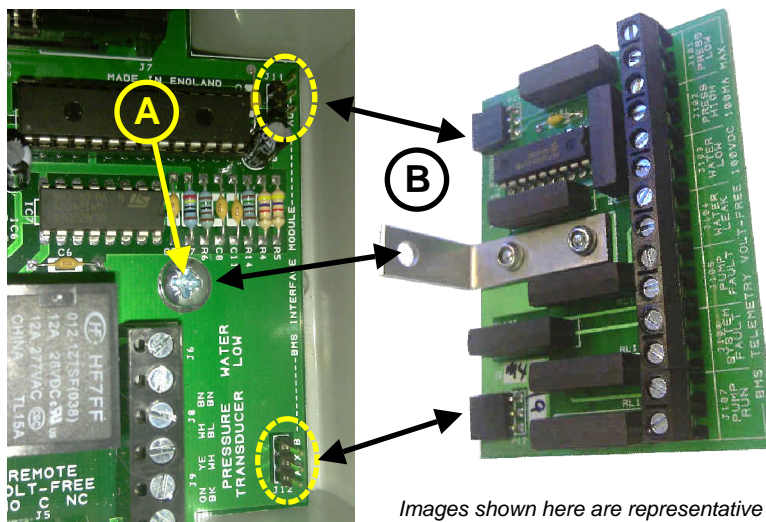

- 1 Remove Screw at 'A'
- 2 For ease and comfort of wiring, connect any required cabling to Accessory Board Terminal Blocks next.
- 3 Carefully plug Accessory Board into the two sets of vertical Header Pins located on the Mainboard (see 'B') ensuring all pins mate accordingly.
- 4 Replace Screw at 'A' to secure Accessory Board.

*Images shown here are representative of range of Accessory and Mainboards available. Procedure for installation applies similarly in all cases.*

K3 Industries  
6th Floor International House  
223 Regent Street  
London W1B 2QD  
United Kingdom  
Tel : +44 (0) 20-8813-1240  
Email : sales@k3planet.com

\*BMS (eg PLC) connection only, unsuitable for inductive loads (eg Relays or Contactors)  
For Technical Support in the first instance contact your distributor.  
Installation should be checked by qualified commissioning engineer before applying any voltage.  
If failure of device can cause damage, ensure a suitable safety backup is fitted.  
Observe all relevant safety precautions, regulations and electrical ratings.  
Observe all precautions for handling electrostatic sensitive devices.  
Specifications for guidance only and subject to change without notice. E&OE.